

SPORT HUB

ARCHITECTURE

JEDDAH, Kingdom of Saudi Arabia 2023, IN PROGRESS

Competition, WON

PROGRAM

TOTAL SURFACE: 25.000m²

Private Sport Center including swimming pool, gymnasium, indoor tennis and outdoor tennis courts, paddels, yoga center, restaurant, coffee shop, shop.

PHASE

IN PROGRESS

The new Sport Hub is situated in a new neighborhood at the west of Jeddah. It will one of the first building that will be built and for this reason it will have to be a landmark, participating to attract people in the new part of the city.

We decided to use typical arab cultural references in a modern way: the roof reminding of the typical arab tent, the wind tower regulating the internal ventilation and temperature, the patterns.

The project will be entirely done with local material and the windtower plus the internal water we located in the lobby, allow with the solar pannel to a reduction of 70% of the energy consumption. The lobby is treated as an internal Oasis, distributing the different part of the program





ZHENGZHOU CULTURAL AND SPORT CENTER

ARCHITECTURE

ZHENGZHOU, CHINA 2019, IN PROGRESS

Competition, WON

PROGRAM

Multipurpose hall 43.000 m² with 15.000 seats in the sport configuration and 20.000 seats in case of Show configuration, training hall 10.000 m², National Fitness Hall 18.000 m², library 17.000 m², the exhibition hall is 10.000 m², the public area is 20.000 m².

TOTAL SURFACE: 118.000m²

CLIENT

CSCEC (ZHENGZHOU) CITY CONSTRUCTION DEVELOPMENT CO., LTD

BUDGET

265M€

PHASE

IN PROGRESS



The design of Zhengzhou Riverside Sports and Cultural Center calls for a network of individual buildings that serves each of its distinct function. A common roof sits on top of the buildings and bridges the separate volumes with a scenic view of a public garden. The rooftop garden is essentially a retreat from the bustling streets beneath – a quiet place that accommodates more introspective activities such as dining, yoga, fitness etc.

The building designated for sports use is designed as a multipurpose hall. Due to its spatial flexibility, the hall could hold sports event, music venue, exhibition, and even serve for educational purposes.

From afar the architectural group looks like a collection of river stones found in the river nearby. Cladded in aluminum metal, the volumes transform the shape of a river stone into a modern expression, drawing connection with the site while faintly reflecting the surrounding. The center, thus, creates a sense of identity and symbolizes to citizens and visitors Zhengzhou's values as a new landmark of the city.

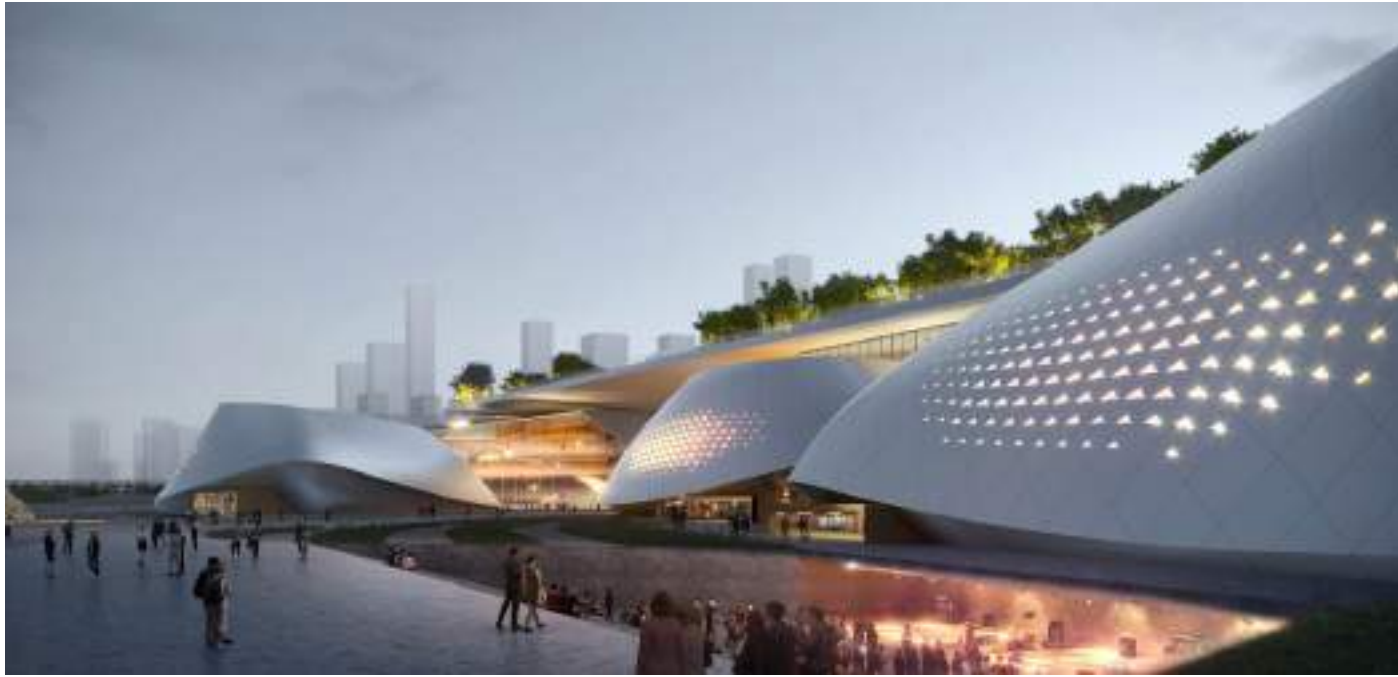

PARC MUNICIPAL DE SPORT

ARCHITECTURE

ISSY LE MOLEAUX, PARIS, FRANCE 2015

Competition

PROGRAM

A new Multisport Building

TOTAL SURFACE: 27.000m²

CLIENT

City of Issy Le Molineau

BUDGET

45M€



LEVEL +46.64 NGF

- RESTAURANT
- ADMINISTRATION - OFFICES

LEVEL +43.60 NGF

- FOOTBALL ACADEMY
- ADMINISTRATION - OFFICES
- HIGH AMBULATORY

LEVEL +39.60 NGF

- RETAILS
- ADMINISTRATION - OFFICES
- EXTERNAL TRIBUNES
- LOW AMBULATORY

LEVEL +37.04 NGF

- RETAILS
- MULTISPORT FIELDS

LEVEL +34.00 NGF

- HIGH RECEPTION
- HEALTH CENTER
- DRESSING ROOMS
- DRESSING ROOMS
- RETAILS
- PUBLIC ANNEXES
- FITNESS ROOM

NIVEAU +30.00 NGF

- RESTAURANT ENTRANCE
- LOW RECEPTION
- PARKING

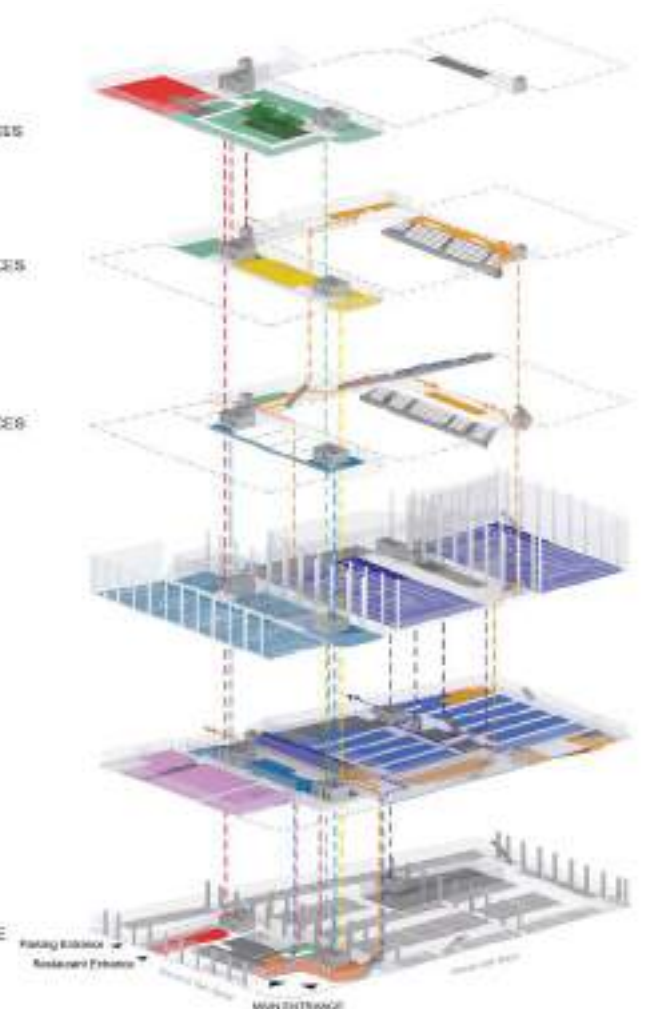

HIPPODROME

ARCHITECTURE

YEONGCHEON, SOUTH KOREA 2016

Competition

PROGRAM

Several Amenities connected to the horse world including:

- Tribune for 12.000 people 15.000m²
- Retails 2.000m²
- Cultural Center 3.000m²

TOTAL SURFACE: 25.000m²

CLIENT

City of Yeongcheon



The Grandstand, the Parade Ring, the Broadcasting Tower, the Exposition Center and several other functions have been thought as one entity which has to reflect the spirit of the entire project.

The building embeds the spirit of the horse and of the surrounding nature. Speed, Lightness and Nature are the three words that inspired the project.

All the different functions are visual connected by a light roof which, by its weaving movement, reminds the surrounding hill's movement. It will be supported by a forest of columns designed as trees which emphasizes the independency of the roof.

Its structure has been thought as an aircraft wing. All the façades of the grandstand are treated with natural materials as wood, vegetal facades, stone. The homogeneous background created creates a strong contrast with the different white concrete stands, putting them in valour and accentuating their lightness. The plan organization has been thought in order to facilitate the accessibility to the different stands by the different categories of the publ

AL THANI - HIPPODROME

ARCHITECTURE

DOHA, QATAR 2014 ON HOLD

Competition, WON

PROGRAM

Hippodrome

Tribunes: 17.000 seats

Commercial Center: 15.000m²

TOTAL SURFACE: 57.000m²

CLIENT

Qatar State

BUDGET

140M€

PHASE

ON HOLD

Located in Al-Khor, the project is composed by a hippodrome for 17.000 people and a luxury commercial center of 15.000m².

The projects will represents one of the main landmark of the Qatar therefore we have been working in a deep connection with the local culture while promoting the modern development the Country is living. The hippodrome is situated below the airplanes landing corridor to Doha, therefor the vision from the sky has been inspiring for the concept. The building is the Qatar "falcon", followed by the golden egg (entrance of the commercial center).

The different volumes containing offices, administration and the commercial center are framed between the different levels of the hippodrome. Facades are treated with metal skin, references to the local tradition with Arabesque pattern screened onto the glass behind and parametrically manipulated to create a translucent mashrabiya.



ARENA 92 NEW SPORT-MULTIPURPOSE FACILITY

ARCHITECTURE

NANTERRE, PARIS, FRANCE 2012, BUILT

Competition, WON

PROGRAM

A new Multipurpose Building: Rugby Stadium, Event Arena from 10.000 to 40.000 seats, variable capacity. Offices.

TOTAL SURFACE: 117.000m²

CLIENT

Racing Arena - Jacky Lorenzetti

BUDGET

350M€

PHASE

BUILT

Scheduled to open in 2017, the "Arena Nanterre-La Défense" is an "indoor" stadium and the ground of the "Racing-Metro 92" rugby team, in the Hauts-de-Seine region. A French sporting legend since 1882, the club was taken over in 2006 by its current president Jacky Lorenzetti. The stadium will also be used as a large performance space accommodating 10,000 to 40,000 people. It will be the largest indoor multipurpose facility with a variable capacity in France.



